

CKD KITS

ENGINE DRIVEN SELF PRIME Twin Impeller (Red Pump Casing)

ENGINE DRIVEN SELF PRIME Single Impeller (Yellow Pump Casing)

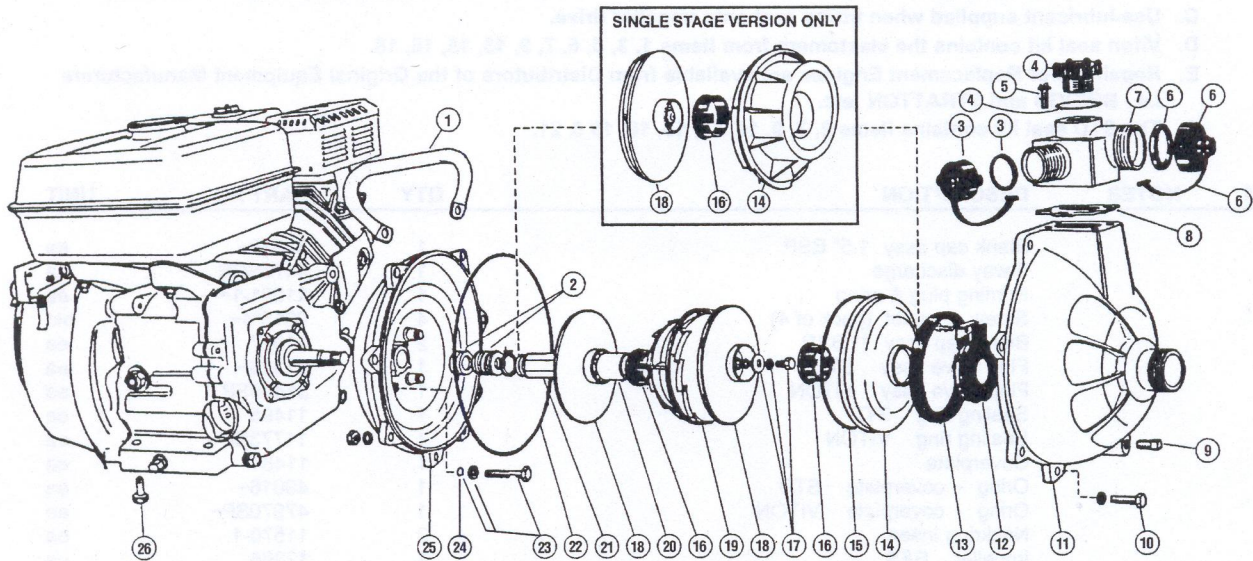

ITEM	NOTES	DESCRIPTION	QTY	PART NO.	UNIT
1		Carry handle - red	1	11388SPR	ea
1		Carry handle - elbow	1	11388SP	ea
2		Seal 5/8"	1	48801~	ea
2		Seal 3/4"	1	48803	ea
3		Blank cap assy 1" BSP	2	31517	ea
4		Priming plug & oring	1	11591-1~	ea
5		Screws - outlet (pack of 4)	4	9615*4~	pkt
6		Blank cap assy 1.5" BSP	1	31518~	ea
7		3-way discharge - red	1	9475SPR	ea
7		3-way discharge - yellow	1	9475SP~	ea
8		Gasket - outlet	1	10494~	ea
9		Plug 1/4" BSP	1	40436*5~	pkt
10		Bolt, nut & washer	8	31328~	ea
11		Casing - red	1	11503SPR	ea
11		Casing - yellow	1	11503SP	ea
12		Checkvalve assy	1	31326~	ea
13		Sealing ring	1	11495	ea
14		Diffuser coverplate - twin impeller	1	11481	ea
14		Diffuser coverplate - single impeller	1	11517	ea
15		Oring - coverplate	1	49016~	ea
16		Neckring insert - twin impeller	2	11570	ea
16		Neckring insert - single impeller	1	11566	ea
17		Shaft kit twin impeller	1	31478~	ea
18		Impeller - twin impeller	2	12306~	ea
18		Impeller 5/8" - single impeller	1	12240~	ea
18		Impeller 3/4" - single impeller	1	12427~	ea
19		Diffuser - twin impeller	1	11480	ea
20		Sleeve/spacer	1	11487	ea
21		Shaft extension 5/8" shaft	1	31564~	ea
21		Shaft extension 3/4" shaft	1	12534-1~	ea
22		Oring - casing	1	45221	ea
23		Bolt kit - yoke to engine (pack of 4)	4	31327*4~	pkt
24		Oring - yoke bolt	4	43064*5~	pkt
25		Yoke - red 5/8" seal	1	11421SPR	ea
25		Yoke - red 3/4" seal	1	11421-2SPR	ea
25		Yoke - yellow 5/8" seal	1	11421SP	ea
25		Yoke - yellow 3/4" seal	1	11421-2SP	ea
26		Engine pad	2	8998*4~	pkt

© Davey Products Pty Ltd 2001

~ Indicates the current Part No. listed has superseded a previous Part No.

Drawings are indicative only, product appearance may change slightly.